

For Dedication of Roads see Dedication Book 1 page 99

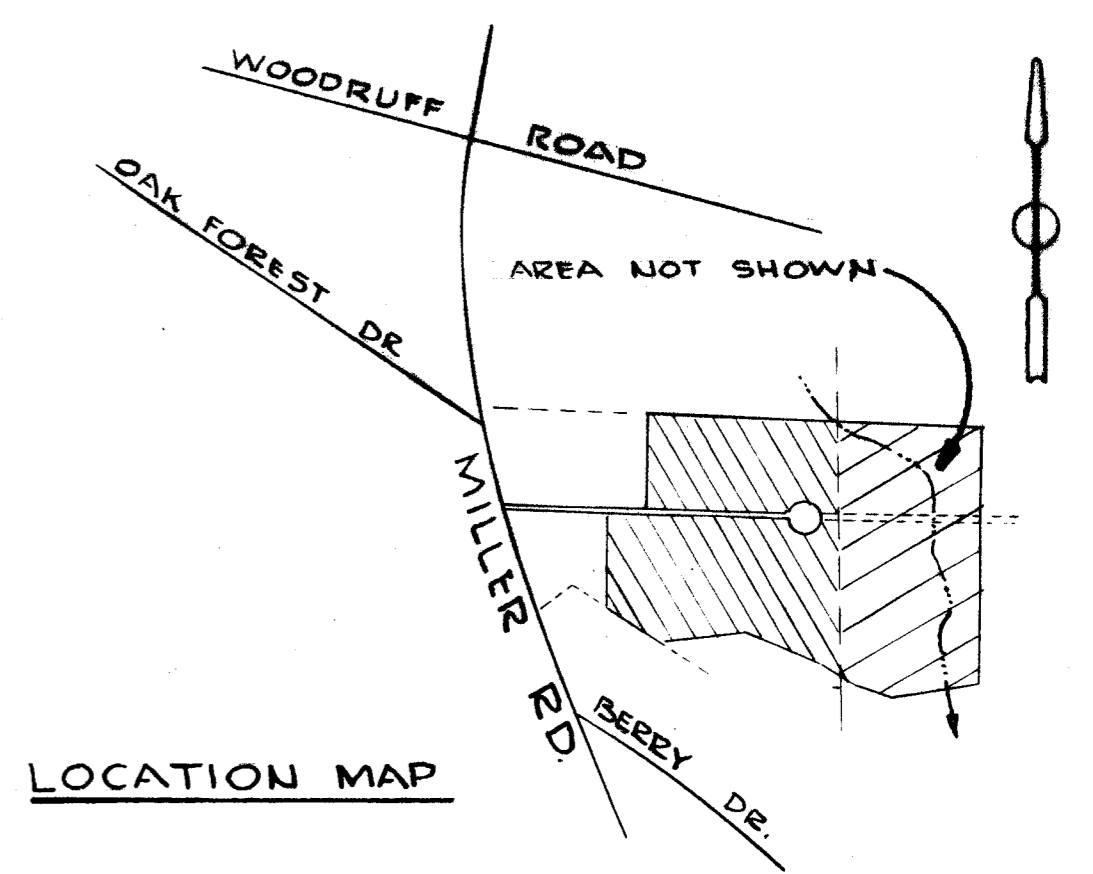

- FINLAY EST. -



CERTIFICATE OF OWNERSHIP AND DEDICATION

"The undersigned hereby acknowledge that I am (we are) the owner(s) of the property shown and described hereon and that I (we) hereby adopt this plan of subdivision with my (our) free consent and that I (we) grant to the minimum building restriction area and hereby dedicate to public use as roads, streets, and easements, forever all areas so shown or indicated on this plat.

6-19-72 Signed *Chubbell A. Carter*
 Signed *Ralph S. Crawley*
 Signed *A. Stephens*

CERTIFICATE OF CORRECTION

"I, _____ (drawn by me) (drawn under my supervision) (an actual survey made under my supervision) (an actual survey made by me) (deed description recorded in Book 941 Page 307, Book _____, Page _____, etc.) (copy); that the error of closure as calculated by _____ is _____; that the boundaries of the surveyed area are shown as broken lines plotted from information found in Book _____, Page _____; that this plat was prepared in accordance with the Greenville County Subdivision Regulations as adopted.

6-19-72 Date Signed *James D. [Signature]*
 Licensed Engineer or Registered Surveyor
 S. C. Registration No. 3320

CERTIFICATE OF APPROVAL FOR RECORDING

"I hereby certify that the subdivision plat shown hereon has been found to comply with the Subdivision Regulations for Greenville County, with the exception of such variances, if any, as are noted in the minutes of the Greenville County Planning Commission of Greenville County, South Carolina and that it has been approved for recording in the office of the County Register of Mens Conveyance."

7-18-1972 Signed *J. Roman Jones*
 Chairman, Secretary, or Director of Planning,
 Greenville County Planning Commission

FILED GREENVILLE CO. S. C. JUN 19 3 10 PM '72 ELIZABETH HIDDLE R.M.C.

FINAL PLAT
FILE NUMBER 72-152

THOUSAND OAKS INDUSTRIAL PARK

CARTER & CRAWLEY, INC. ETAL. OWNER
PIEDMONT ENGINEERS ARCHITECTS SURVEYOR

ZONED I-1

NO. OF ACRES 35.4± MILES OF NEW ROADS 0.23.
 NO. OF LOTS 72 DATE 6-9-72
 ERROR OF CLOSURE 1/4000

SCALE 1" = 100'

100 0 100 200 300

PERFORMANCE BOND POSTED FOR RECORDATION APPROVAL

No county street maintenance will take place on any street shown on this plat until the release of this bond.

Bond Release: _____ 19____ Director of Planning Greenville County Planning Commission

1766 19 July 35A 3:16 P.

4R-25A